

HOMECARE SHOWER STOOL & SHOWER CHAIR ASSEMBLY INSTRUCTIONS

BTS118025 | BTS119035

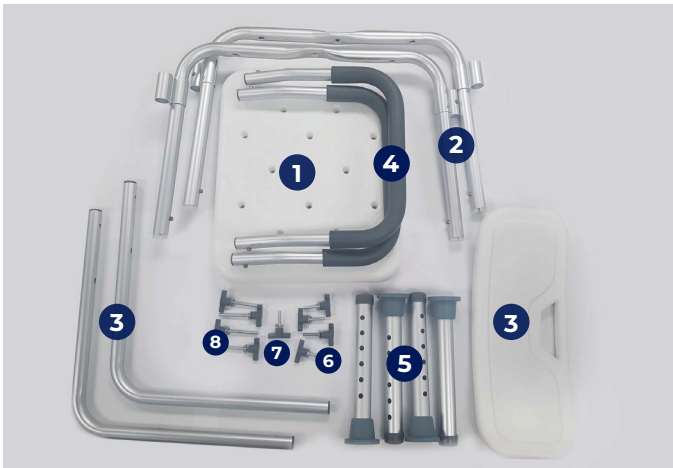

Carton Contains:

1. Seat (x1)
2. Leg supports (x2)
3. Backrest and supports (x2)
4. Armrests (x2)
5. Adjustable legs (x4)
6. Small hand wheel bolt (x4)
7. Medium hand wheel bolt (x1)
8. Large hand wheel bolt (x4)

NOTE: Shower stools do not contain backrests or large hand wheel bolts.

ASSEMBLY INSTRUCTIONS

- 1 Lay seat on a flat surface and mount leg supports across the seat, securing in place with the medium hand wheel bolt **7** in the centre of the seat.



- 2 Fasten back supports **3** in place across leg supports, screw in place in all 4 x corners (through both tubes) with hand wheel bolts (large size) **7**.

NOTE: This applies to the shower chair only. For shower stools, screw hand wheel bolts in the same 4 x corners, not through backrest tubes.

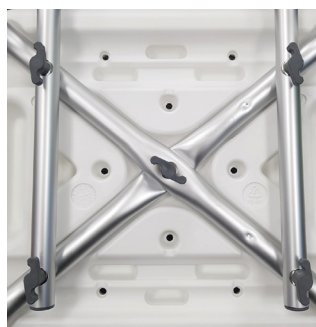

- 3 Fasten leg extension tubes onto leg supports.
NOTE: 1 x leg extension tube has extra holes on it to handle uneven surfaces, please ensure all 4 x legs are at the same height prior to use.

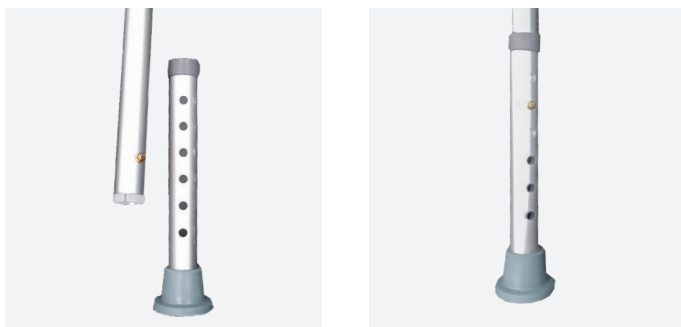

- 4 Fasten armrests into receivers on either side of the frame, ensuring 4 x locking pins (2 x either side) are locked in place.

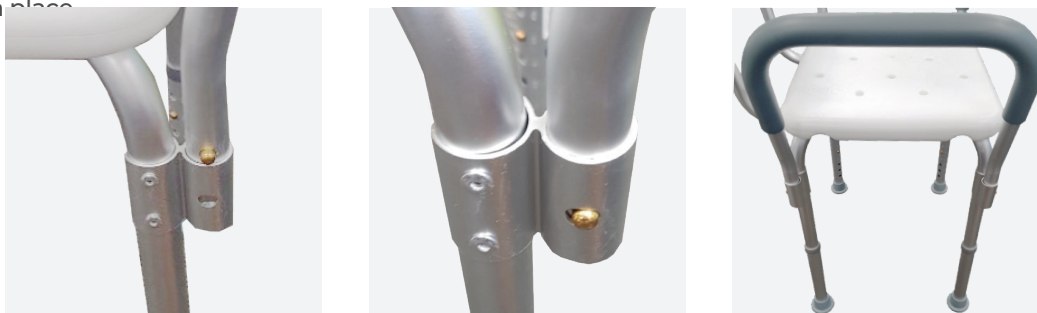

- 5 Fasten backrest to back supports, fasten in place with 4 x hand wheel bolts (small size).
NOTE: This is only applicable for the Shower Chair, not the Shower Stool.



- 6 Check and ensure all handwheel bolts (both small and large) are fastened in place, armrest pins are secured and locked in place and that all 4 x legs are at the same height, your Aspire Homecare Shower Chair or Stool is now ready for use.



LEG HEIGHT ADJUSTMENT



Before use, adjust height of each leg to your specific needs, making sure all legs are at the same height. When desired height is reached, lock legs into place by aligning buttons into proper holes, per illustration.

AIDACARE PTY LTD

Building 3A, 1 Moorebank Avenue,
 Moorebank NSW Australia 2170

1300 133 120 | aspirecare.com.au

ASUM72.6 090323

